

3-28. FUEL TANK FILLER CAP AND SPOUT MAINTENANCE

This task covers:

- | | |
|-----------------|-----------------------------------|
| a. Removal | d. Fuel Filler Chain Removal |
| b. Inspection | e. Fuel Filler Chain Installation |
| c. Installation | |

INITIAL SETUP:

Tools

General mechanic's tool kit:
automotive (Appendix B, Item 1)

Equipment Condition

Fuel tank drained (para. 3-24).

Materials/Parts

Four locknuts (Appendix G, Item 70)
Sealing compound (Appendix C, Item 44)

General Safety Instructions

Do not perform this procedure near fire, flames, or sparks.

Manual References

TM 9-2320-280-10
TM 9-2320-280-24P

WARNING

Diesel fuel is highly flammable. Do not perform this procedure near fire, flames, or sparks. Severe injury or death will result.

a. Removal

1. Unscrew filler cap "T" handle (7) and remove filler cap (6) from filler spout (12).
2. Detach cap chain clip (8) from filler spout (12) and remove filler cap (6).
3. Disconnect vent line (1) from fitting (2).
4. Remove three locknuts (3), washers (4), capscrews (5), and washers (4) from spout mounting ring (9). Discard locknuts (3).
5. Loosen clamp (17) securing filler spout (12) to hose (18).
6. Remove locknut (13), washer (14), capscrew (16), washer (14), and clamp (15) from filler spout (12). Discard locknut (13).
7. Push filler spout (12) out of spout mounting ring (9) and remove filler spout (12) from hose (18).
8. Remove fitting (2) from filler spout (12).
9. Using handle (10), remove screen (11) from filler spout (12).

b. Inspection

Inspect screen (11) for damage, debris, or blockage. Replace if damaged or if debris or blockage is detected.

c. Installation

1. Apply sealing compound to fitting (2) and install fitting (2) on filler spout (12).
2. Align filler spout (12) with hose (18) and push filler spout (12) into hose (18).
3. Install filler spout mounting ring (9) to body with three washers (4), capscrews (5), washers (4), and locknuts (3).
4. Secure hose (18) to filler spout (12) and tighten clamp (17).
5. Secure filler spout (12) to body with clamp (15), washer (14), capscrew (16), washer (14), and locknut (13). Tighten locknut (13) to 6 lb-ft (8 N·m).
6. Apply sealing compound to fitting (2) and connect vent line (1) to fitting (2).

3-28. FUEL TANK FILLER CAP AND SPOUT MAINTENANCE(Cont'd)

7. Using handle (10), install screen (11) in filler spout (12).
8. Attach filler cap chain clip (8) to filler spout (12).
9. Install filler cap (6) to filler spout (12) and secure with "T" handle (7).

d. Fuel Filler Chain Removal

NOTE

Replacement chain manufacturing instructions can be found in appendix D, figure 15.1.

1. Unscrew "T" handle (7) and remove filler cap (6) from filler spout (12).
2. Detach cap chain clip (8) from filler spout (12) and remove chain clip (8) from chain (5.1).
3. Pry open link holding chain (5.1) to cap (6), and remove chain (5.1) from cap (6).

e. Fuel Filler Chain Installation

1. Pry open link on end of chain (5.1) and attach to filler cap (6). Close link.
2. Hook chain clip (8) through last link at opposite end of chain (5.1) and attach to filler spout (12).
3. Install filler cap (6) to filler spout (12) and secure with "T" handle (7).

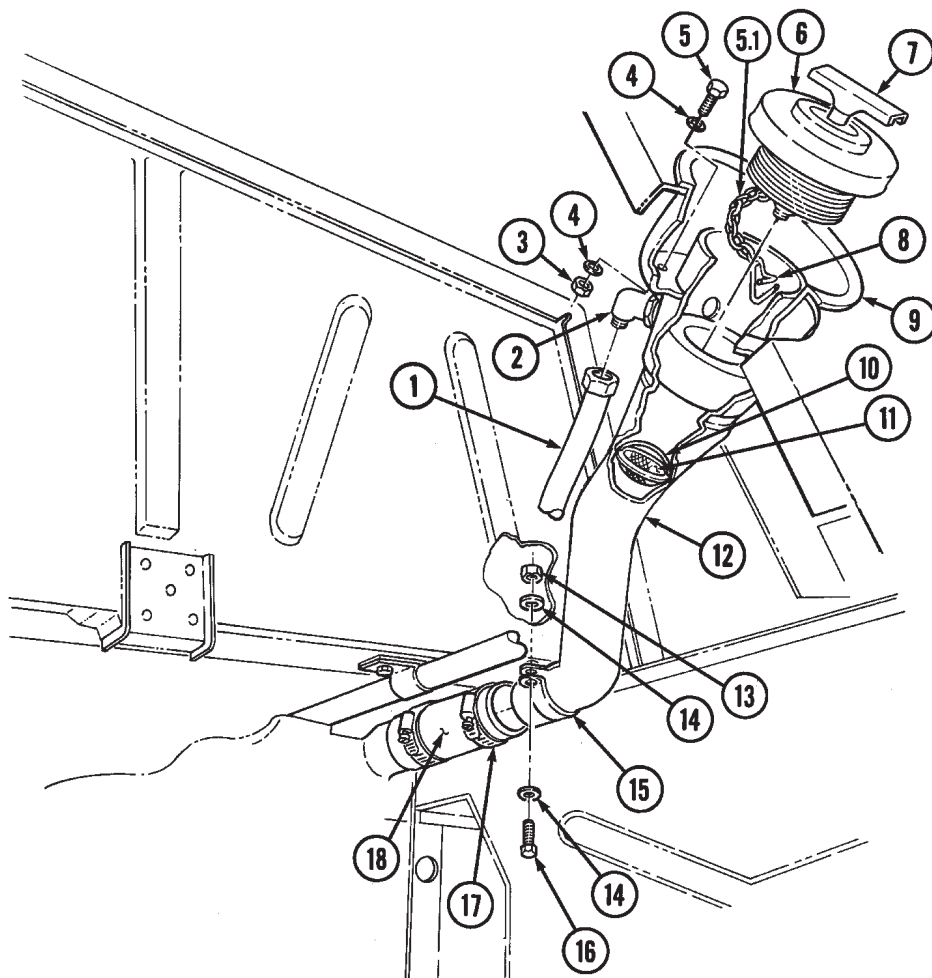

FOLLOW-ON TASK: Fill fuel tank (TM 9-2320-280-10) and check filler spout for fuel leaks.

3-29. FUEL TANK FILLER SPOUT VENT LINE REPLACEMENT

This task covers:

a. Removal

b. Installation

INITIAL SETUP:

Tools

General mechanic's tool kit:
automotive (Appendix B, Item 1)

Manual References

TM 9-2320-280-24P

Materials/Parts

Locknut (Appendix G, Item 70)
Adhesive (Appendix C, Item 1)
Sealing compound (Appendix C, Item 46)

Equipment Condition

Rear propeller shaft removed (para. 6-4).

a. Removal

1. Disconnect vent line (2) from fuel filler spout elbow (3).
2. Remove locknut (7), washer (5), capscrew (4), and washer (5) securing vent line (2) and clamp (6) to body (1). Discard locknut (7).
3. Disconnect and remove vent line (2) from tee (12).
4. Disconnect vent line (10) from tee (12).
5. Remove capscrew (15) securing vent line (10) and clamp (11) to body (1).
6. Loosen two nuts (13) to allow access to elbow (8).
7. Disconnect vent line (10) from elbow (8) on fuel tank (9), cut vent line (10), and remove vent line (10) from crossmember (14).

b. Installation

NOTE

Use sealing compound on all vent line connector threads before installation.

1. Install vent line (10) and connect to elbow (8) on fuel tank (9).

NOTE

Upper and lower straps should be approximately 1/2 in. (12 mm) apart after tightening locknuts. Straps should not touch when properly installed. Straps must be replaced if upper and lower straps touch.

2. Apply adhesive to threads of nuts (13) and tighten nuts (13) to 23-27 lb-in. (3-5 N•m).
3. Install clamp (11) and vent line (10) to body (1) with capscrew (15).
4. Route vent line (10) through crossmember (14).
5. Connect vent line (10) to tee (12).
6. Install vent line (2) and connect to tee (12).
7. Install vent line (2) and clamp (6) on body (1) with washer (5), capscrew (4), washer (5), and locknut (7). Tighten locknut (7) to 6 lb-ft (8 N•m).
8. Connect vent line (2) to fuel filler spout elbow (3).

3-29. FUEL TANK FILLER SPOUT VENT LINE REPLACEMENT (Cont'd)

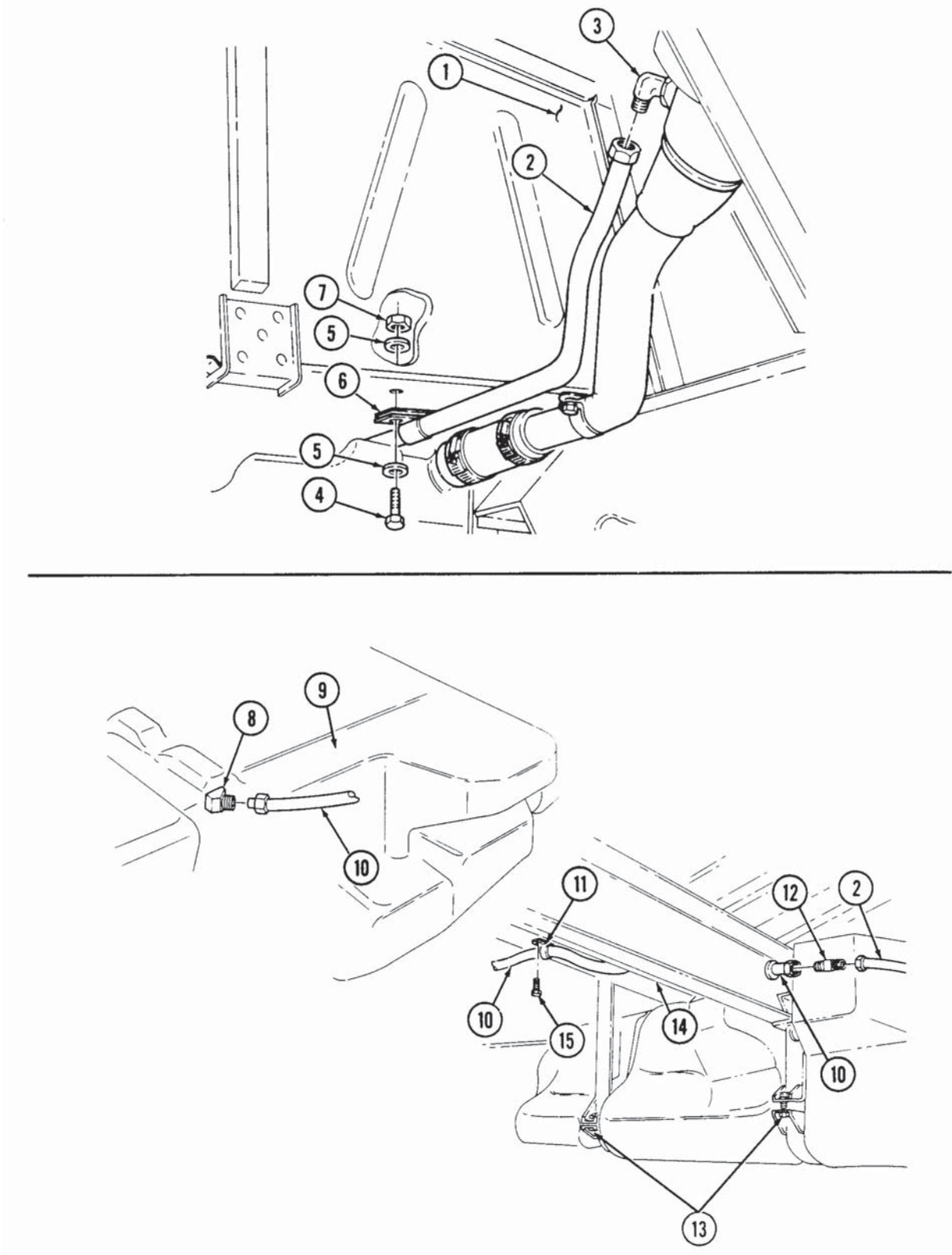

FOLLOW-ON TASK: Install rear propeller shaft (para. 6-4).

3-30. FILLER SPOUT HOSE REPLACEMENT

This task covers:

a. Removal

b. Installation

INITIAL SETUP:

Tools

General mechanic's tool kit:
automotive (Appendix B, Item 1)

Equipment Condition

Fuel tank drained (para. 3-24).

Manual References

TM 9-2320-280-10
TM 9-2320-280-24P

General Safety Instructions

Do not perform this procedure near fire, flames, or sparks.

WARNING

Diesel fuel is highly flammable. Do not perform this procedure near fire, flames, or sparks. Severe injury or death will result.

a. Removal

1. Loosen clamps (4) and (3) securing hose (1) to fuel tank (5) and to filler spout (2).
2. Slide hose (1) on to filler spout (2) until disconnected from fuel tank (5). Remove hose (1) from filler spout (2).

b. Installation

NOTE

Position clamps attaching filler hose to fuel tank as shown.

1. Install hose (1) on filler spout (2) and slide on filler spout (2) until the hose (1) clears fuel tank (5).
2. Connect hose (1) to fuel tank (5) and tighten clamps (3) and (4).

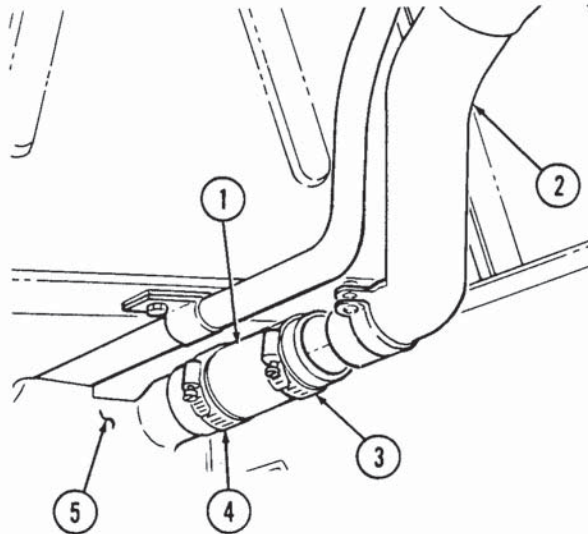

FOLLOW-ON TASK: Fill fuel tank (TM 9-2320-280-10) and check for leaks.