

3-54. RIGHT EXHAUST MANIFOLD REAR HEAT SHIELD REPLACEMENT

This task covers:

a. Removal

b. Installation

INITIAL SETUP:

Tools

General mechanic's tool kit:
automotive (Appendix B, Item 1)

Equipment Condition

Engine access cover removed (para. 10-15).

Materials/Parts

Locknut (Appendix G, Item 72)

General Safety Instructions

Do not touch hot exhaust system components with bare hands.

Manual References

TM 9-2320-280-24P

WARNING

Do not touch hot exhaust system components with bare hands.
Severe injury will result.

a. Removal

1. Remove locknut (6), capscrew (2), and clamp (1) from rear heat shield (7) and transmission dipstick tube (3). Discard locknut (6).
2. Remove capscrew (5) and rear heat shield (7) from heat shield (4).

b. Installation

1. Install rear heat shield (7) on heat shield (4) with capscrew (5).
2. Install clamp (1) and rear heat shield (7) on transmission dipstick tube (3) with capscrew (2) and locknut (6).

3-54. RIGHT EXHAUST MANIFOLD REAR HEAT SHIELD REPLACEMENT(Cont'd)

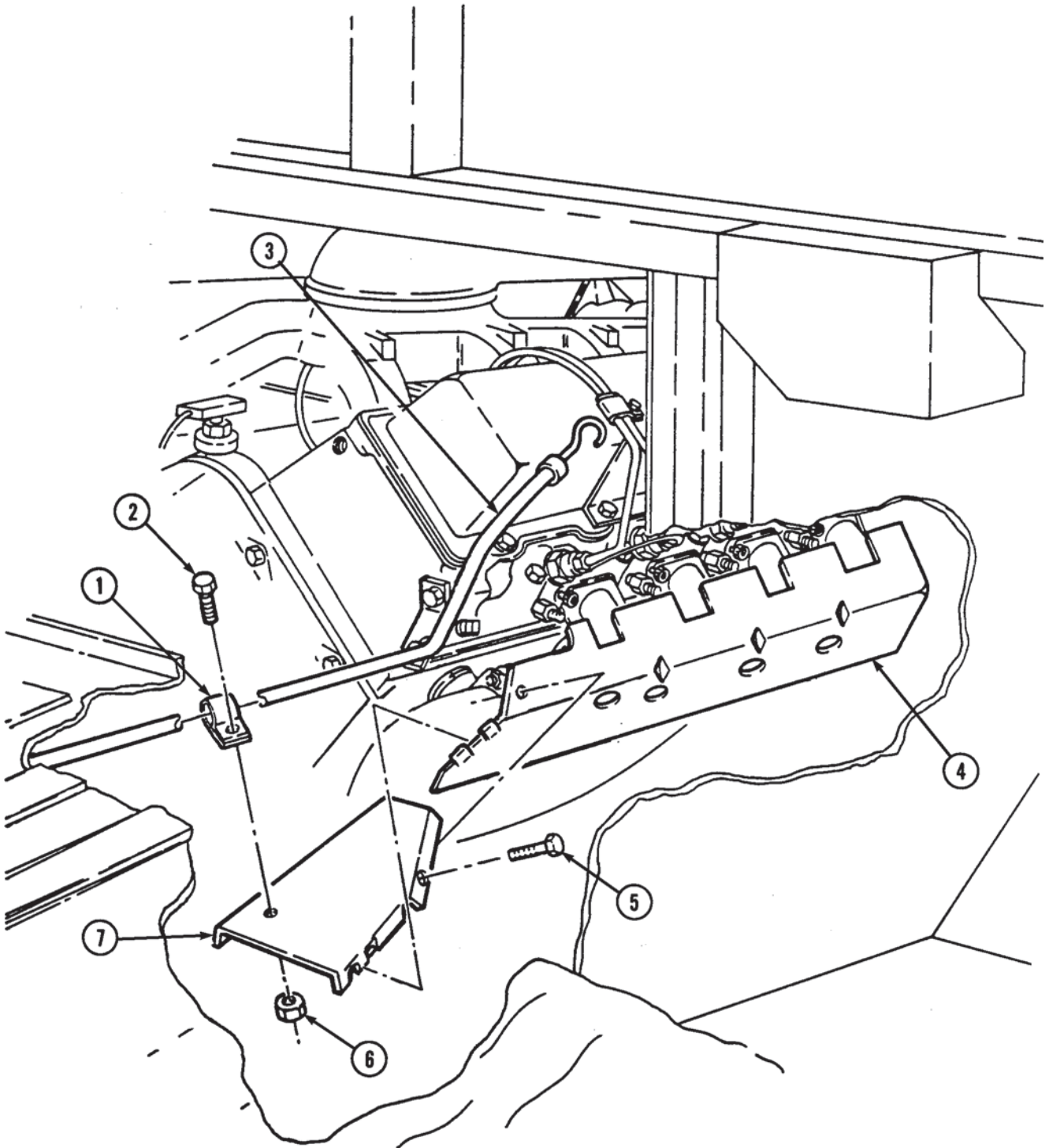

FOLLOW-ON TASK: Install engine access cover (para. 10-15).

3-55. RIGHT EXHAUST MANIFOLD HEAT SHIELD REPLACEMENT

This task covers:

a. Removal

b. Installation

INITIAL SETUP:

Tools

General mechanic's tool kit:
automotive (Appendix B, Item 1)

Manual References

TM 9-2320-280-10
TM 9-2320-280-24P

Special Tools

Hex-head driver, 8mm (Appendix B, Item 156)

Equipment Condition

- Right exhaust manifold rear heat shield removed (para. 3-54).
- Hood raised and secured (TM 9-2320-280-10).
- Engine access cover removed (para. 10-15).

Materials/Parts

Locknut (Appendix G, Item 128)

General Safety Instructions

Do not touch hot exhaust system components with bare hands.

Personnel Required

One mechanic
One assistant

WARNING

Do not touch hot exhaust system components with bare hands.
Severe injury will result.

a. Removal

1. Using hex-head driver, loosen three socket head screws (3) on heat shield (4), exhaust manifold (2), and cylinder head (1).
2. Remove locknut (7), washer (6), capscrew (5), washer (6) and heat shield (4) from crossover pipe (8) and exhaust manifold (2). Discard locknut (7).

b. Installation

1. Position heat shield (4) on exhaust manifold (2) and crossover pipe (8).
2. Using hex-head driver, secure heat shield (4) and exhaust manifold (2) to cylinder head (1) with three socket-head screws (3). Tighten socket-head screws (3) to 25-33 lb-ft (34-45 N•m).
3. Install heat shield (4) on exhaust manifold (2) and crossover pipe (8) with washer (6), capscrew (5), washer (6), and locknut (7). Tighten locknut (7) to 37 lb-ft (50 N•m).

3-55. RIGHT EXHAUST MANIFOLD HEAT SHIELD REPLACEMENT (Cont'd)

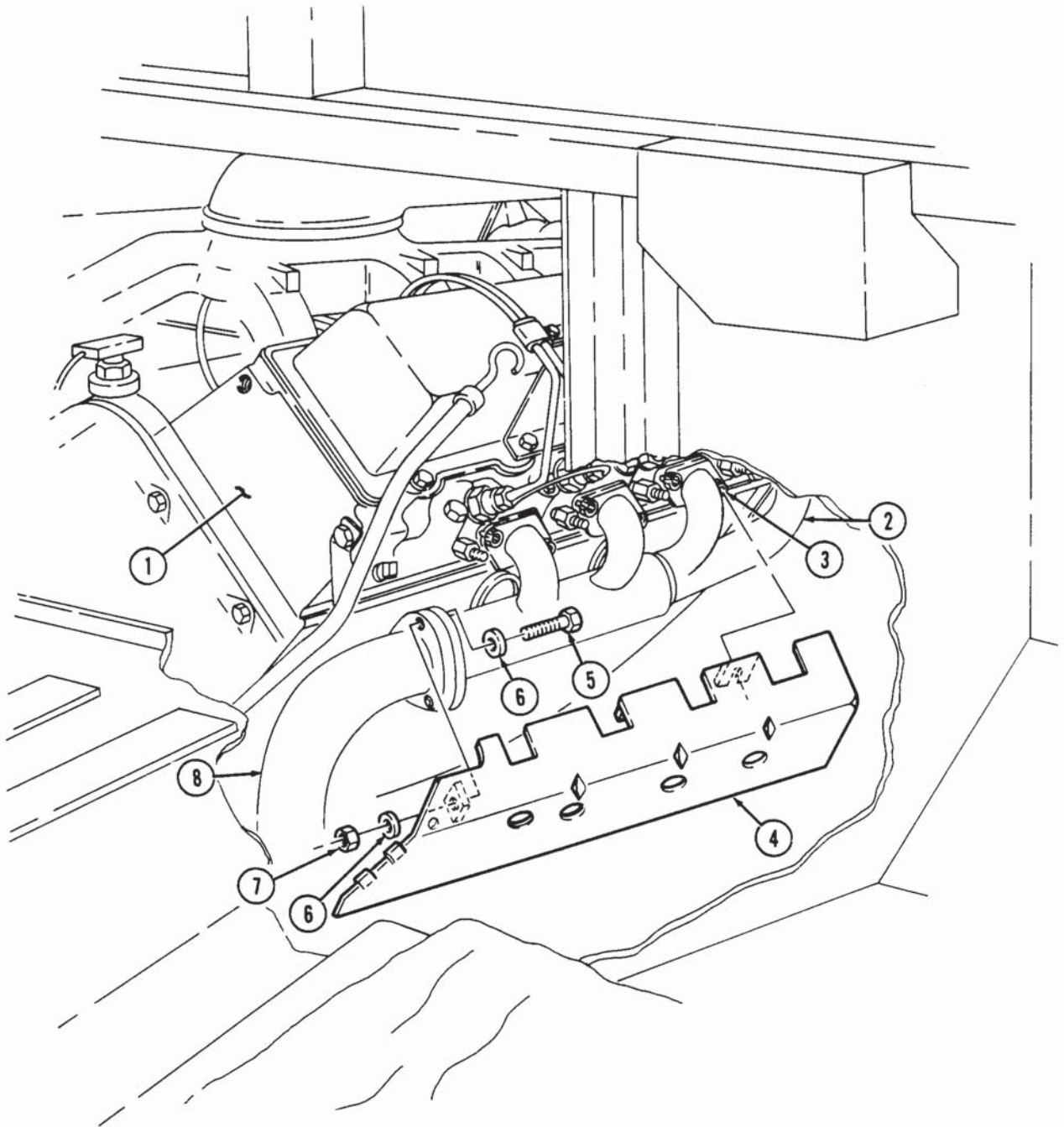

- FOLOW-ON TASK:**
- Install right exhaust manifold rear heat shield (para. 3-54).
 - Install engine access cover (para. 10-15).
 - Start engine (TM 9-2320-280-10) and check for exhaust leaks.
 - Lower and secure hood (TM 9-2320-280-10).