

3-2. ENGINE OIL DIPSTICK TUBE REPLACEMENT

This task covers:

a. Removal

b. Installation

INITIAL SETUP:

Tools

General mechanic's tool kit:
automotive (Appendix B, Item 1)

Manual References

TM 9-2320-280-10
TM 9-2320-280-24P

Special Tools

Hex-head driver, 8 mm
(Appendix B, Item 156)

Equipment Condition

Hood raised and secured (TM 9-2320-280-10).

Materials/Parts

O-ring (Appendix G, Item 209)
Plain-assembled nut (Appendix G, Item 201)
Sealant (Appendix C, Item 38)

a. Removal

1. Remove oil dipstick (5) from oil dipstick tube (4).
2. Remove plain-assembled nut (3) and capscrew (13) from harness clamp (2) and upper dipstick tube bracket (6). Discard plain-assembled nut (3).
3. Using hex-head driver, remove socket-head screw (8) and washer (7) from lower dipstick tube bracket (12) and exhaust manifold (11).
4. Remove two assembled-washer screws (1) from upper dipstick tube bracket (6) and fuel line bracket (14).
5. Remove oil dipstick tube (4) from engine oil pan (10). Remove and discard O-ring (9).

b. Installation

1. Apply RTV sealant to O-ring (9) and install O-ring (9) on oil dipstick tube (4).
2. Install oil dipstick tube (4) in engine oil pan (10).
3. Using hex-head driver, secure lower dipstick tube bracket (12) to exhaust manifold (11) with washer (7) and socket-head screw (8). Tighten socket-head screw (8) to 25-33 lb-ft (34-45 N•m).
4. Secure upper dipstick tube bracket (6) to fuel line bracket (14) with two assembled-washer screws (1). Tighten assembled-washer screws (1) to 3-4 lb-ft (4-5 N•m).
5. Secure harness clamp (2) to upper dipstick tube bracket (6) with capscrew (13) and plain-assembled nut (3).
6. Install oil dipstick (5) into oil dipstick tube (4).

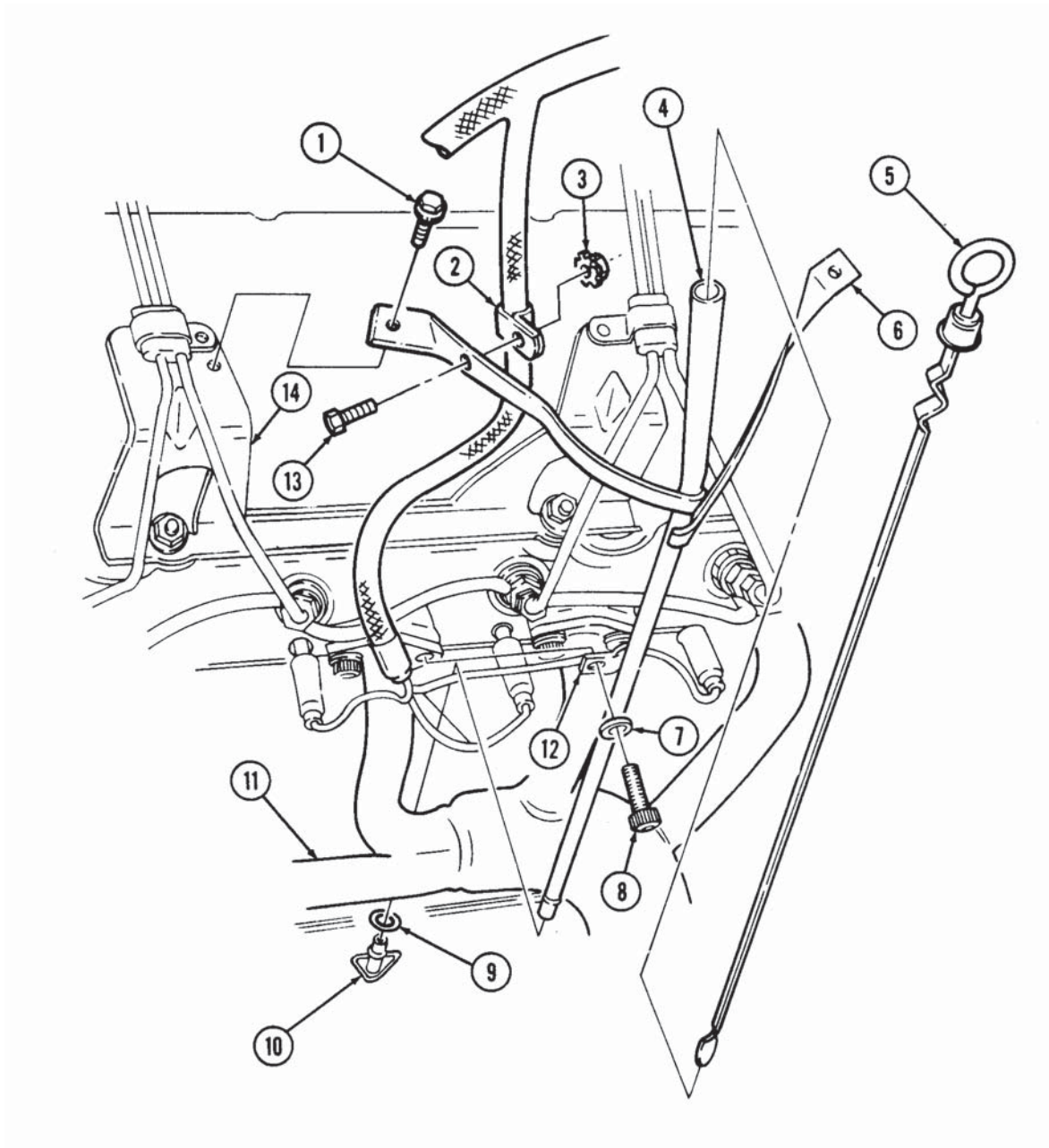
3-2. ENGINE OIL DIPSTICK TUBE REPLACEMENT (Cont'd)

FOLLOW-ON TASKS:

- Start engine (TM 9-2320-280-10) and check for oil leaks.
- Lower and secure hood (TM 9-2320-280-10).