

3-6. OIL PAN REPLACEMENT

This task covers:

a. Removal

b. Installation

INITIAL SETUP:

Tools

General mechanic's tool kit:
automotive (Appendix B, Item 1)

Materials/Parts

Oil seal retainer (Appendix G, Item 207)
Two lockwashers (Appendix G, Item 135)
Oil pan gasket (Appendix G, Item 61)
(optional - used on 6.2 L only)
Sealant (Appendix C, Item 38)

Manual References

TM 9-2320-280-10
TM 9-2320-280-24P

Equipment Condition

- Starter removed (para. 4-8).
- Oil dipstick tube removed (para. 3-2).

General Safety Instructions

Do not drain oil when engine is hot.

a. Removal

WARNING

Do not drain oil when engine is hot. Severe injury to personnel will result.

NOTE

Have drainage container ready to catch oil.

1. Remove oil drainplug (8) and gasket (7) and drain oil. Install gasket (7) and oil drainplug (8) after oil is drained.
2. Remove two nuts (9), lockwashers (10), and starter cable support bracket (11) from studs (14). Discard lockwashers (10).

NOTE

Optional gasket applies to 6.2 L only.

3. Remove twenty capscrews (6), two large capscrews (13), studs (14), oil pan gasket (4) (if installed), and oil pan (12) from cylinder block (2). Remove any sealant remains.
4. Remove oil pan rear seal retainer (15) from rear main cap (1). Discard oil pan rear seal retainer (15).

b. Installation

1. Apply a bead of sealant to each end of seal retainer (15) and install oil pan rear seal retainer (15) on rear main cap (1).

NOTE

- Perform step 2 for oil pan gasket (if installed). Perform step 3 for applying sealant.
 - Immediately install oil pan after application of sealant.
2. Install oil pan gasket (4) on lip of oil pan (12) and align with bolt holes.
 3. Apply a 3/16 in. (5mm) bead of sealant around two large holes (3) on cylinder block (2). Apply a 3/16 in. (5mm) bead of sealant around oil pan sealing surface (5) following sealant diagram shown.
 4. Install oil pan (12) on cylinder block (2) with twenty capscrews (6), two large capscrews (13), and studs (14). Tighten capscrews (6) and studs (14) to 4-10 lb-ft (5-14 N•m). Tighten large capscrews (13) to 13-20 lb-ft (18-27 N•m).
 5. Install starter cable support bracket (11) on studs (14) with two lockwashers (10) and nuts (9).
 6. Tighten oil drainplug (8) to 20 lb-ft (27 N•m).

3-6. OIL PAN REPLACEMENT (Cont'd)

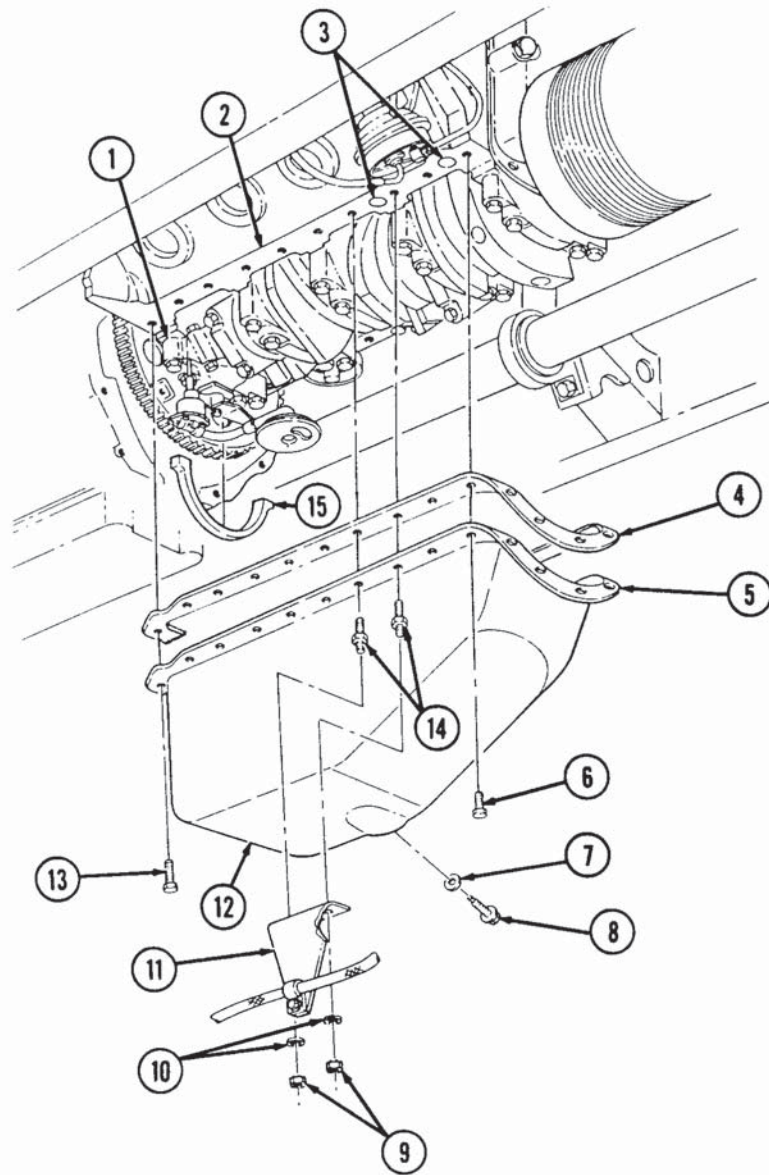

SEALANT DIAGRAM

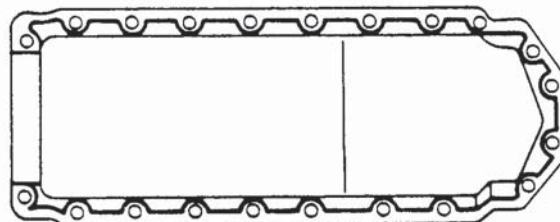

- FOLLOW-ON TASKS:**
- Replenish engine oil (TM 9-2320-280-10).
 - Install oil dipstick tube (para. 3-2).
 - Install starter (para. 4-8).