

4-52. FRONT COMPOSITE LIGHT ASSEMBLY REPLACEMENT

This task covers:

a. Removal

b. Installation

INITIAL SETUP:

Tools

General mechanic's tool kit:
automotive (Appendix B, Item 1)

Manual References

TM 9-2320-280-10
TM 9-2320-280-24P

Materials/Parts

Adhesive sealant (Appendix C, Item 10)

Equipment Condition

Battery ground cable disconnected (para. 4-73).

NOTE

- The procedure to remove and install right and left composite light assemblies is basically the same except left side has four screws securing close-off cover and right side has three screws. This procedure covers the left composite light.
- Prior to removal, tag leads for installation.

a. Removal

1. Remove four screws (1), washers (2), and close-off cover (3) from hood (4).
2. Disconnect leads 20 (5), 461 (12), and 491 (11) from hood wiring harness (6).
3. Remove two capscrews (9), washers (8), ground 92 (7), buss bar (10), and composite light (13) from hood (4).

b. Installation

NOTE

To prevent water from accumulating between the composite light access cover and the hood, general purpose RTV adhesive sealant should be applied to the inside of the cover. Clean and reapply RTV when removing and reinstalling the cover.

1. Install composite light (13), buss bar (10), and ground 92 (7) on hood (4) with two washers (8) and capscrews (9).
2. Connect lead 20 (5), 461 (12), and 491 (11) to hood wiring harness (6).
3. Install close-off cover (3) to hood (4) with four washers (2) and screws (1).

4-52. FRONT COMPOSITE LIGHT ASSEMBLY REPLACEMENT (Cont'd)

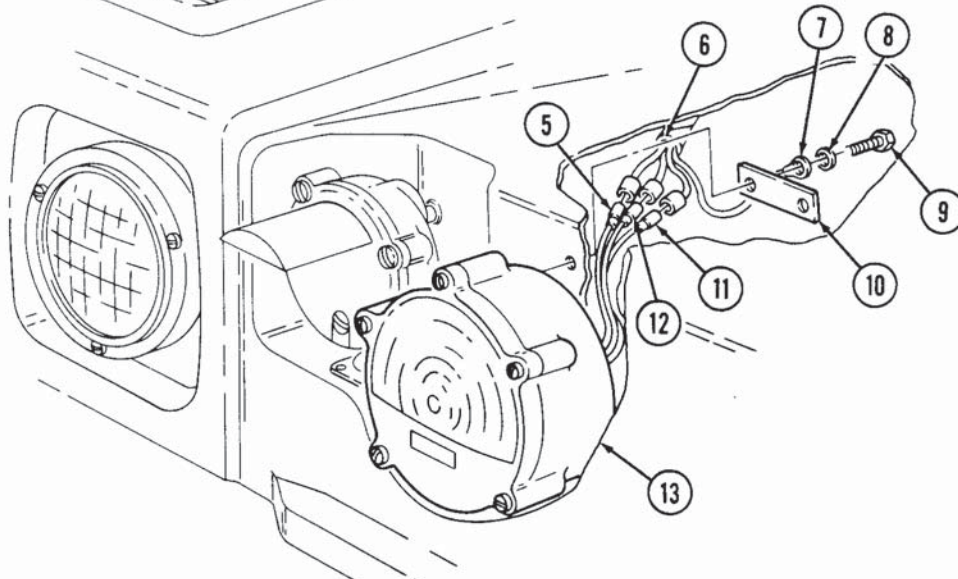
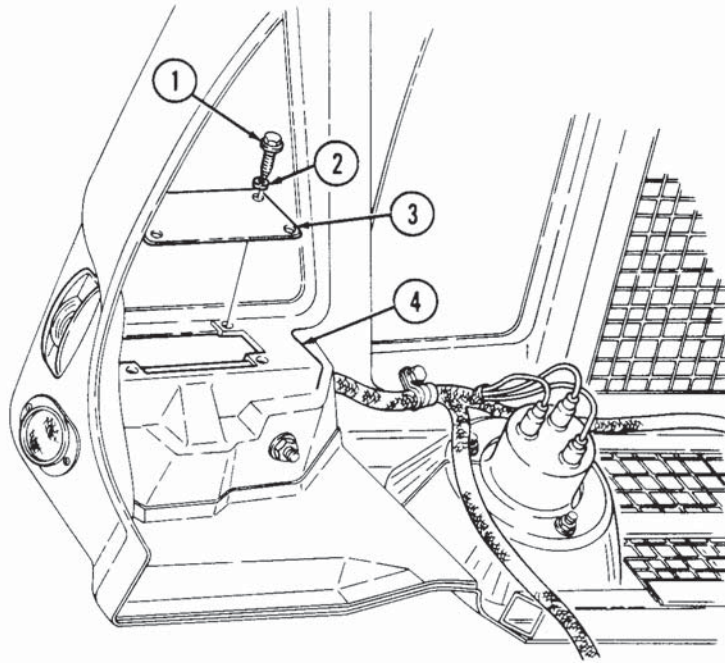

- FOLLOW-ON TASKS:**
- Connect battery ground cable (para. 4-73).
 - Lower and secure hood (TM 9-2320-280-10).
 - Check front composite light for proper operation (TM 9-2320-280-10).

4-53. FRONT COMPOSITE LIGHT LAMP REPLACEMENT

This task covers:

a. Removal

b. Installation

INITIAL SETUP:

Tools

General mechanic's tool kit:
automotive (Appendix B, Item 1)

Manual References

TM 9-2320-280-10
TM 9-2320-280-24P

Materials/Parts

O-ring (Appendix G, Item 220)
Adhesive sealant (Appendix C, Item 10)

Equipment Condition

Battery ground cable disconnect (para. 4-73).

a. Removal

1. Loosen five retaining screws (1) and remove light door (2) and O-ring (5) from light body (3). Discard O-ring (5).
2. Remove lamp (4).
3. Clean mating surface on light door (2) and light body (3). Remove sealant.

b. Installation

1. Install lamp (4).

NOTE

To prevent moisture from entering light assembly, tighten all screws evenly.

2. Install O-ring (5) and light door (2) on light body (3) with five retaining screws (1).
3. Apply thin coat of sealant to seam between light body (3) and light door (2).

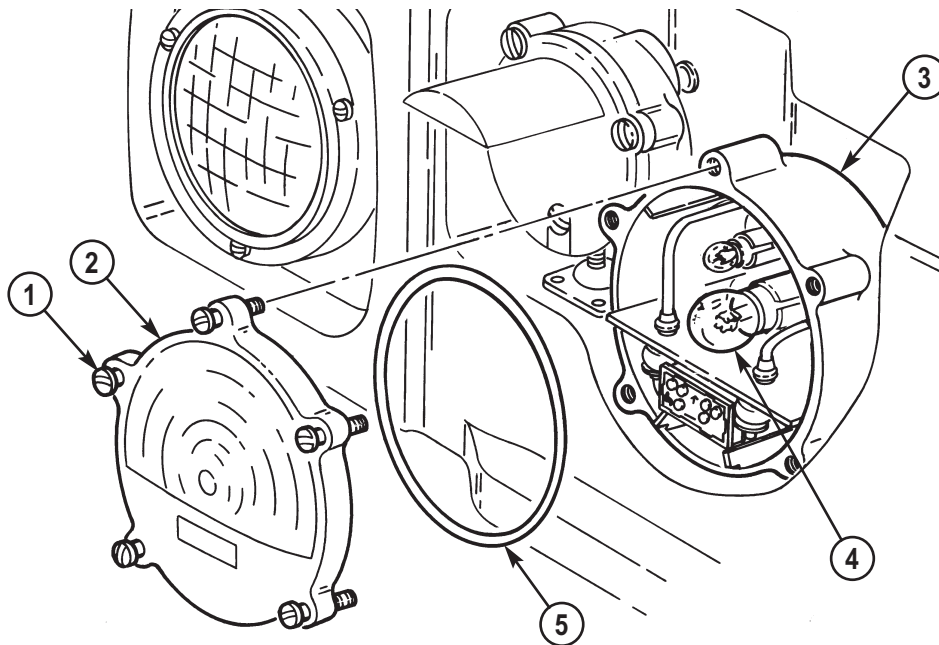

- FOLLOW-ON TASKS:**
- Connect battery ground cable (para. 4-73).
 - Check front composite light for proper operation (TM 9-2320-280-10).