

4-56. REAR COMPOSITE LIGHT ASSEMBLY REPLACEMENT

This task covers:

a. Removal

b. Installation

INITIAL SETUP:

Tools

General mechanic’s tool kit:
automotive (Appendix B, Item 1)

Manual References

TM 9-2320-280-10
TM 9-2320-280-24P

Materials/Parts

Two lockwashers (Appendix G, Item 135)

Equipment Condition

Battery ground cable disconnect (para. 4-73).

NOTE

Prior to removal, tag leads for installation.

a. Removal

1. Remove two capscrews (3), washers (4), ground 95B (5), and ground strap (6) from housing (17).
2. Remove two capscrews (15), lockwashers (16), and pull shield (1) away from “D” beam (14). Discard lockwashers (16).
3. Remove screw (2), nut (12) and clamp (11) from shield (1).
4. Disconnect leads 21 (7), 23 (8), 24 (9), and 22-461 (10) from body harness (13).
5. Remove composite light (18) from housing (17).

b. Installation

1. Install composite light (18) on housing (17).
2. Connect leads 21 (7), 23 (8), 24 (9), and 22-461 (10) to body harness (13).
3. Install clamp (11) on shield (1) with screw (2) and nut (12).
4. Install shield (1) on “D” beam (14) with two capscrews (15) and lockwashers (16).
5. Install ground strap (6) and ground 95B (5) on housing (17) with two washers (4) and capscrews (3).

4-56. REAR COMPOSITE LIGHT ASSEMBLY REPLACEMENT (Cont'd)

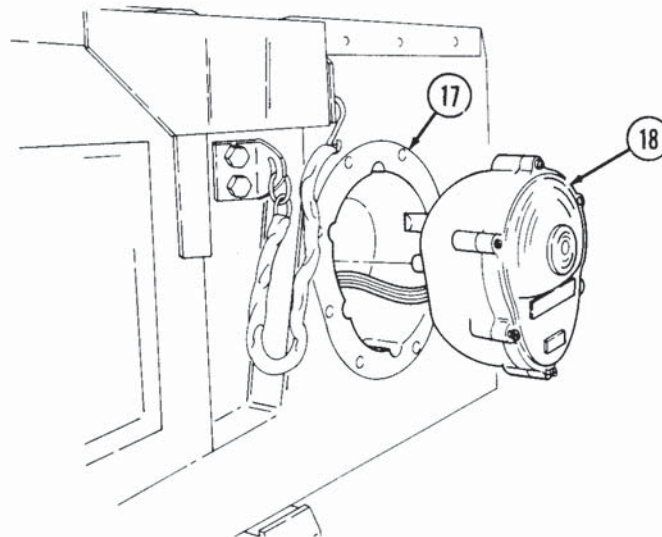
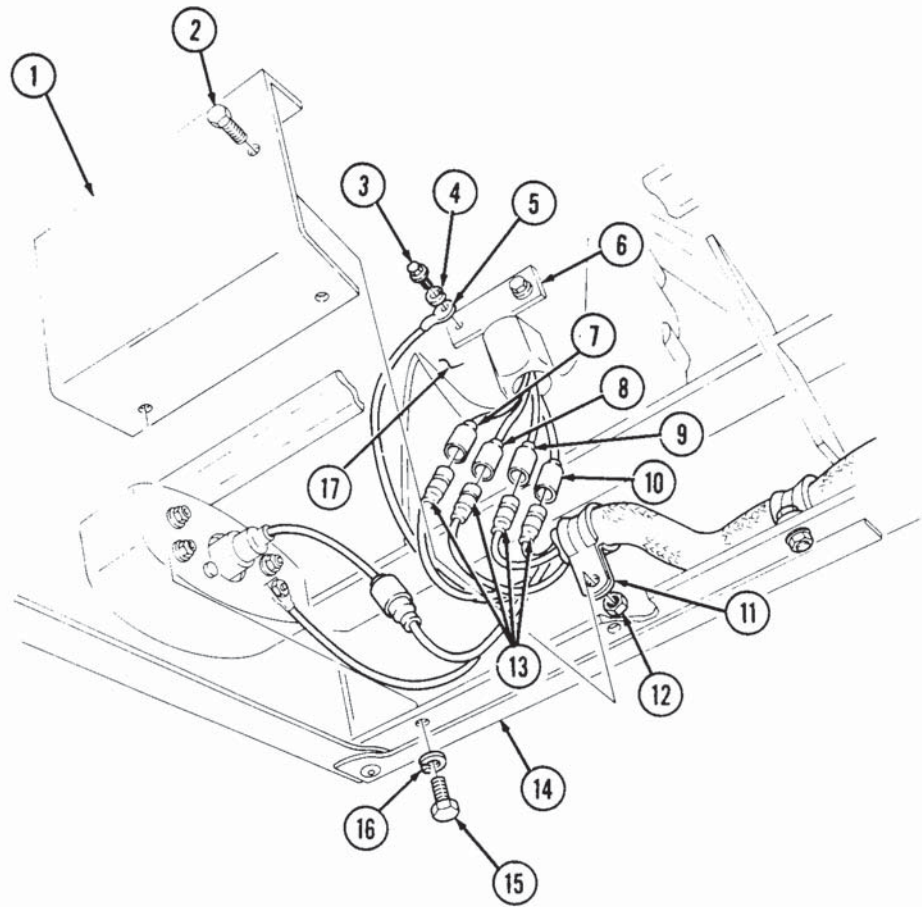

- FOLLOW-ON TASKS:
- Connect battery ground cable (para. 4-73).
 - Check rear composite light for proper operation (TM 9-2320-280-10).

4-57. REAR COMPOSITE LIGHT LAMP REPLACEMENT

This task covers:

a. Removal

b. Installation

INITIAL SETUP:

Tools

General mechanic's tool kit:
automotive (Appendix B, Item 1)

Manual References

TM 9-2320-280-10
TM 9-2320-280-24P

Materials/Parts

O-ring (Appendix G, Item 221)
Adhesive sealant (Appendix C, Item 10)

Equipment Condition

Battery ground cable disconnect (para. 4-73).

a. Removal

1. Loosen six retaining screws (3) and remove composite light door (4) and O-ring (5) from composite light (1). Discard O-ring (5).
2. Remove lamp (2).
3. Clean mating surface on light door (4) and composite light (1). Remove sealant.

b. Installation

1. Install lamp (2).

NOTE

To prevent moisture from entering light assembly, tighten all screws evenly.

2. Install O-ring (5) and composite light door (4) on composite light (1) with six screws (3).
3. Apply a thin coat of sealant to seam between composite light (1) and composite light door (4).

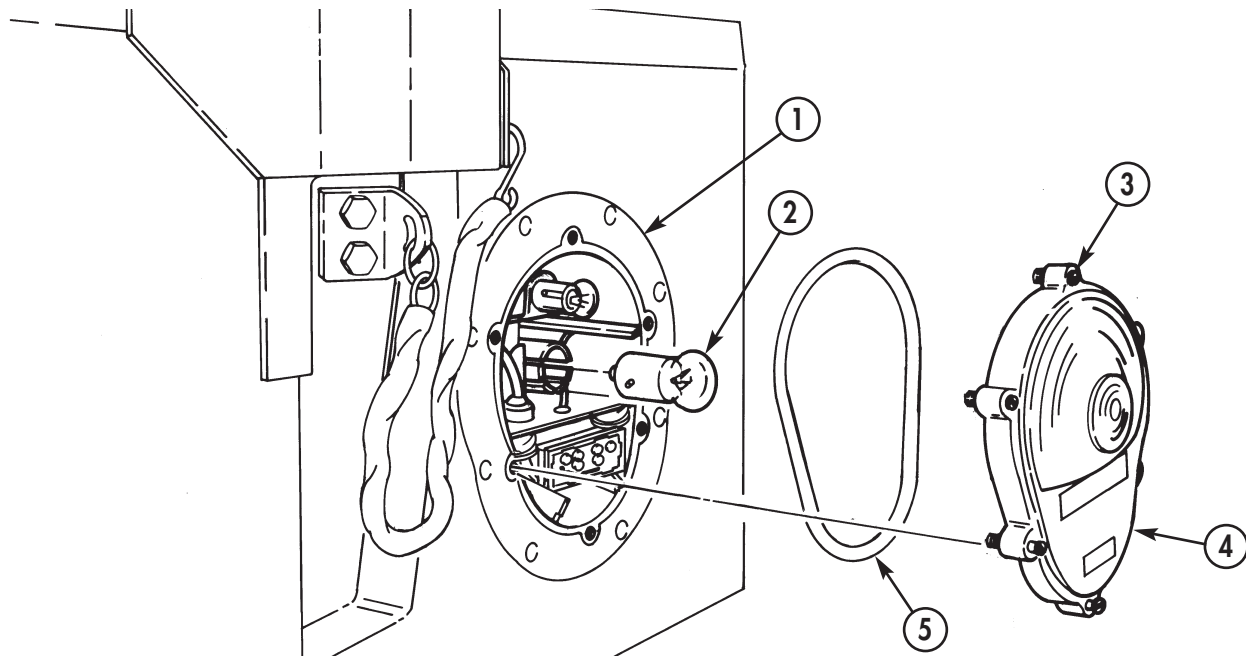

- FOLLOW-ON TASKS:**
- Connect battery ground cable (para. 4-73).
 - Check front composite light for proper operation (TM 9-2320-280-10).