

4-34. BACKUP LIGHT SWITCH REPLACEMENT

This task covers:

a. Removal

b. Installation

INITIAL SETUP:

Applicable Models

M996, M996A1, M997, M997A1, M997A2,
M1035, M1035A1, M1035A2

Tools

General mechanic's tool kit:
automotive (Appendix B, Item 1)

Material/Parts

Sealing compound (Appendix C, Item 44)

Manual References

TM 9-2320-280-24P

Equipment Condition

Shift controls housing removed (para. 5-7 or 5-11).

a. Removal

1. Remove boot (4) from shift control housing assembly (1).

NOTE

Perform step 2 for M996, M996A1, M997, M997A1, M1035, and M1035A1 vehicles. Perform steps 3 and 4 for M997A2 and M1035A2 vehicles.

2. Remove backup light switch (3) from shift control housing assembly (1).
3. Remove two screws (6) and lockwashers (7) from backup light switch (8) and housing (1). Discard lockwashers (7).
4. Remove tiedown strap (10) and backup light switch (8) from neutral start switch (9).

b. Installation

NOTE

Perform steps 1 through 3 for M997A2 and M1035A2 vehicles. Perform steps 4 and 5 for M996, M996A1, M997, M997A1, M1035, and M1035A1 vehicles.

1. Install backup light switch (8) on shift controls housing (1) with two lockwashers (7) and screws (6).
2. Install tiedown strap (10) on leads from backup light switch (8) and neutral start switch (9).
3. Position neutral start switch (9) leads and backup light switch (8) leads through boot (4) and install boot (4) on housing (1).
4. Apply sealing compound to threads of backup light switch (3), and install backup light switch on shift control assembly (1).
5. Position leads from neutral start switch (2), backup light switch (3), and shift selector indicator (5) through boot (4) and install boot (4) on shift control housing assembly (1).

4-34. BACKUP LIGHT SWITCH REPLACEMENT (Cont'd)

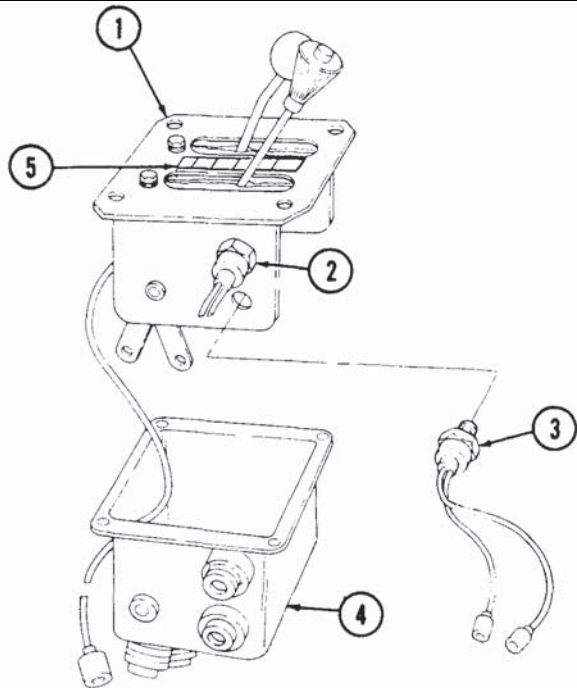

M996, M996A1, M997, M997A1, M1035, and M1035A1 vehicles only

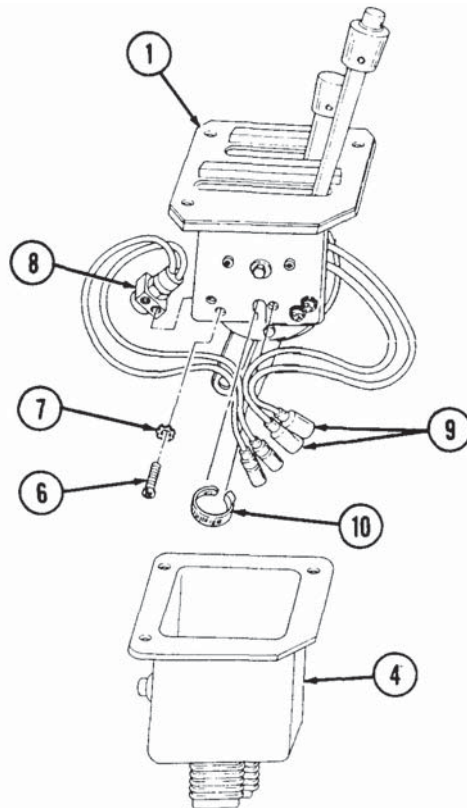

M997A2 and M1034A2 vehicles only

FOLLOW-ON TASK: Install shift controls housing (para. 5-7 or 5-11).